

# SCHOOL BUS



# EVACUATION DRILL

Spring 2021



# Safety & Evacuation Drill

We are going to cover some important bus safety information and review what to do in an emergency during a bus evacuation drill.





## Bus Seats

The school bus is the safest form of transportation on the road. The seats are designed to contain students and keep students safe when they remain seated, sit facing forward and keep arms & legs out of the aisle.



# Avoid the Danger Zone

The danger zone is a 10-foot area around the bus and it's hard for the driver to see students in this area. While waiting for the bus, it is important to stand in a safe place away from traffic, especially in bad weather. If you have to cross the street to get to or away from the bus, wait for the driver to motion you across when it is safe and **always** be alert to traffic, looking both ways.

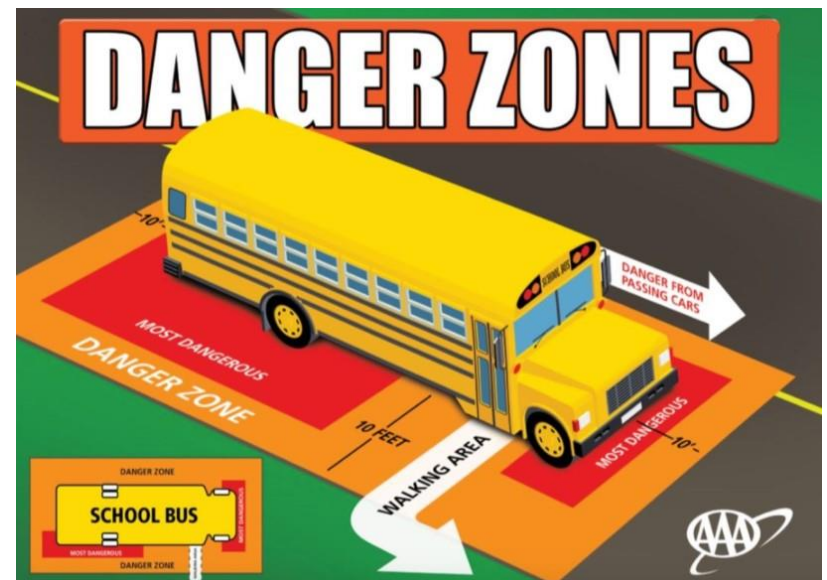





# Safety things on a bus:



Fire Extinguisher



First Aid Kit



Caution Triangles

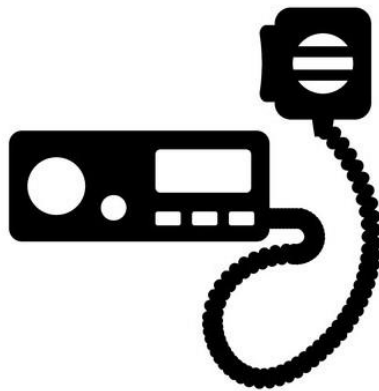

2-Way Radio



Emergency Brake



Emergency Door &  
Windows



# Evacuation Drills

We perform drills twice a year to remind students of the way we safely leave the bus in the event of an actual emergency.

The drill is done at the school when the bus arrives at the school.





# Evacuation Drill COVID Safety

1. Masks On
2. Social Distancing





# Evacuation Drill Safety

1. Stay calm
2. Stay quiet
3. Listen
4. Move Quickly & Safely







# Evacuation Drill Helpers

The driver will ask or assign  
4 students as helpers.

- 1 dismisses students from each seat
- 2 help students slide from the back of the bus
- 1 meets the students back at the front door of the bus.





# Back Door Evacuation Drill

- A helper will dismiss you from your seat
- Walk to the back of the bus
- Stop, Drop & Slide off the bus
- No Jumping! Helpers will assist you off the bus.
- Walk around to the front entrance helper.
- Driver will check that no students are on the bus
- Driver will close the back door & let students back on the bus at the front door

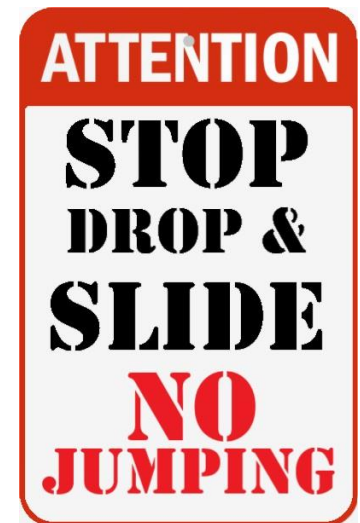



# Front Door Evacuation Drill

- The driver will dismiss you from your seat
- Walk to the front of the bus
- Use handrails
- Helpers will guide you away from the bus
- Driver will check that no students are on the bus
- Driver will join you outside the bus until clear

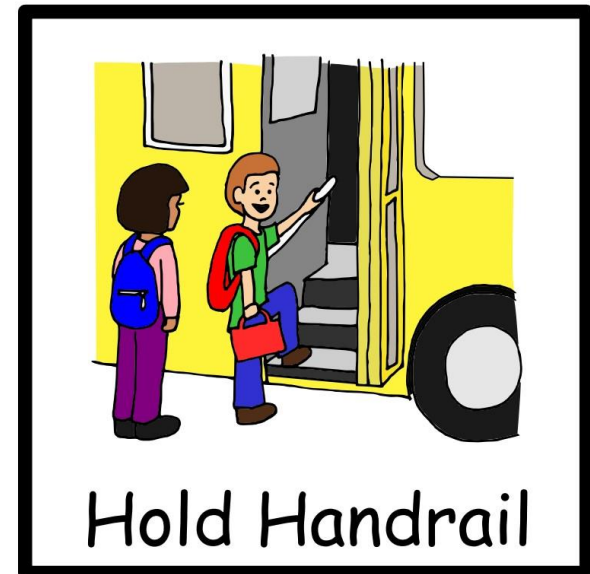



# Evacuation Student Flow

(● Designates Helper )

## Back of Bus

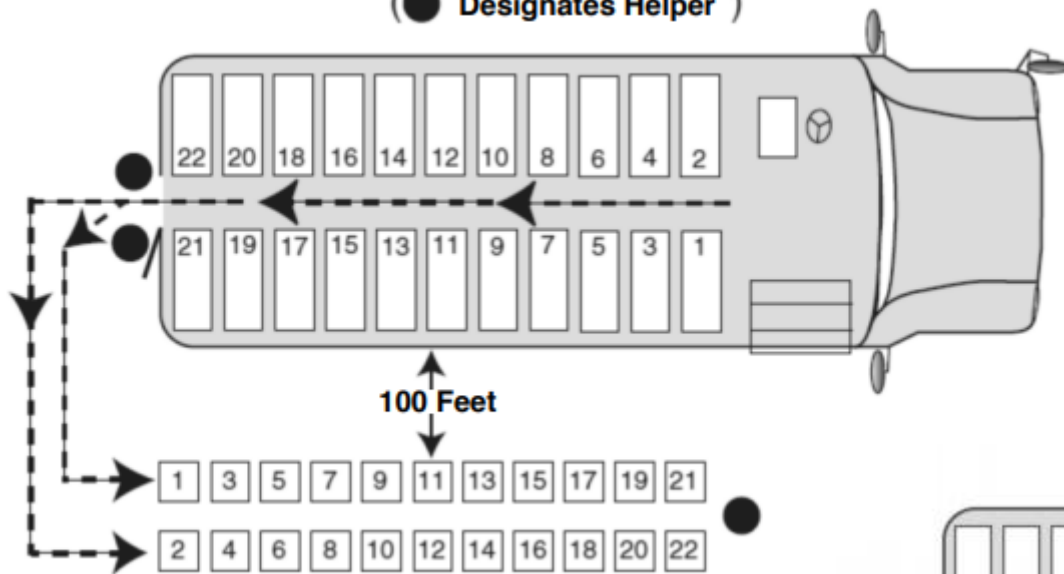

(● Designates Helper )

## Front of Bus

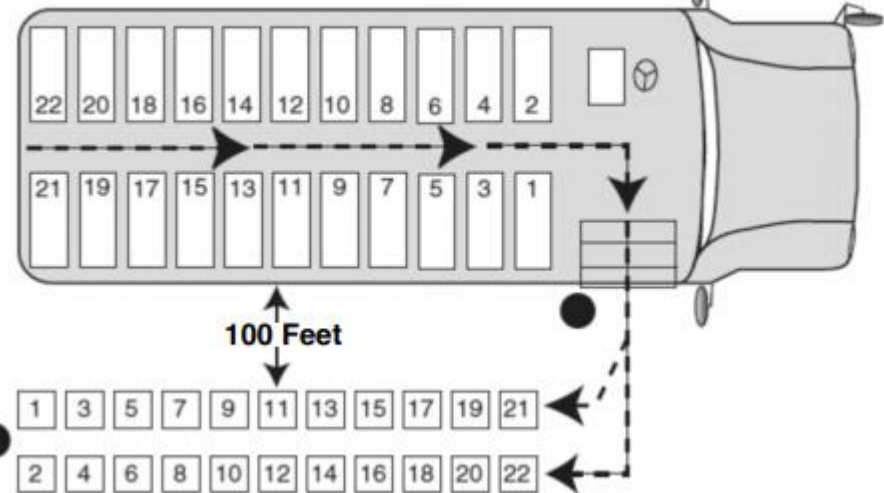



# Parent Information Page

Student safety is always our first concern. Evacuating a bus is only used when there is danger to the students if they stay on the bus.

- Our drivers will be in direct contact with the Transportation Office who will call the police / fire.
- Students will be positioned 100 feet away from the bus in a safe area.
- All students **MUST** stay in the safe area until released by the authorities.
- Depending on the nature of the emergency, parents will be notified to pick up children either at the scene or be transported to a safe location (nearby school) or home.





**Driving Our Most  
Precious Cargo**

**Thank you!**